

Additional clinics will benefit patients

On Thursday 3 May 2007, staff from the Gastroenterology and Hepatology Department celebrated the opening of their new Portacom.

The new facility includes administration offices and 2 clinic rooms, which will cater for Hepatitis C, Gastroenterology and Haematology outpatients.

“The Portacom will make a huge difference to our patients,” says Gastro Consultant Stephen Gerred.

“Lack of nursing staff and clinic space meant we could only treat 40-50 Hepatitis C outpatients per year. We are now aiming to treat 100 outpatients per year and will have 6 nurse led Hepatitis C treatment clinics per week.”

The project took 18 months to complete and was funded by Pharmaceutical Company Roche.



The Gastroenterology and Hepatology team outside their new Portacom



The Portacom weighing several tons is lifted into place

Roche is funding the ongoing rental of the Portacom and a part-time Clinical Nurse Specialist (CNS) salary.

“We are delighted with the end result,” says Clinical Head Susan Parry. “Special thanks to Medical Operations Manager, Alex Boersma and Stephen Gerred for bringing everything together. It was a great team effort.”

Launch of new logo

Project Excel has a new look - one that represents our journey towards 20/20. The colours link in with the CMDHB colours and the triangle gives the impression of moving forward.

Middlemore Footbridge to open late June 2007

The new Footbridge, which will replace the current at grade railway crossing will open late June 2007.



The new Middlemore Footbridge

As the picture shows there will be glazing on each side of the lift tower. The bridge will be open air, but has been designed to accommodate a cover to the walkway, if required in the future.

Access to the bridge will be via stairs or a lift on each side of the platform.

The bridge and lift areas will be well lit and monitored via CCTV (closed circuit television) cameras.

The work is being carried out by ARTNL (Auckland Regional Transport Network Ltd) and is part of a bigger project to revamp a total of 11 passenger rail stations and associated facilities.

Middlemore Station will be upgraded to accommodate a six-car train and the old station buildings will be replaced by modern, safer structures with streamlined canopies for better shelter.

This will include improved lighting, seating, tactile strips, rubbish bins, access and security (CCTV cameras) and better signage and train information.

Construction update - Women's Health

Building works for the Assessment and Birthing Unit (ABU) and Ante and Postnatal Care Wards (ANPN) are underway and remain on schedule for completion mid September 2007 (ANPN) and October 2007 (ABU).

Lists of furniture, fittings and equipment for ABU and ANPN have been confirmed and purchasing will commence shortly.

Demolition is well underway on old Ward 20, which will become the new Gynaecology Care Unit. All redundant walls and services have been removed and the area is being readied for building work to commence. Completion date is October 2007.



East corridor – Gynae Care Unit



ABU high acuity delivery room



ANPN framing – west corridor

Upgrade plans for Emergency Care

Upgrade plans are underway for Emergency Care's Adult Assessment area. This includes centralising the staff base and relocating the medication room.

"Our aim is to make the staff base 'open plan', increasing visibility of clinical areas, improving staff flow and improving the way we work," says Emergency Care Nurse Manager, Mary McManaway.



Adult Assessment Area

At peak times up to 30 staff members (nurses, doctors and clerical staff) can be found working in the staff base.

"At the moment our clinical staff tend to work in fragmented areas," says Mary.

"This is partly due to the design of the current staff base, which isn't conducive to efficient staff flow. At peak times the staff base can become very congested with staff from other areas.

"The upgrade has also given us an opportunity to look at the way we work," says Mary. "It's not simply a matter of knocking down a couple of walls. It's ensuring that the work space supports how we work. For example the relocation of the medical room to a centralised location will improve access for staff in all areas of assessment."

The Whanau room will also get a much needed 'make-over'. This room is used by families and friends who have loved ones in the resuscitation area.

"Hector Trust have kindly donated a television, couches, coffee and tea maker. This will make a huge difference," says Mary.

"Carrying out renovations around a busy Department, has its challenges," says CMDHB minor works supervisor, Nathan Linton.

“Our trades-people are very mindful that building works must be carried out with minimal disruption to the running of the Department. This is where expert local knowledge is so important.

“We have a variety of trades-people working on this project ranging from Carpenters to Engineers. Each one has specialised knowledge of Emergency Care and knows what is required to get the job done properly and on time.”

Construction will commence early June 2007 and will take approximately 6 weeks to complete.

Below is a diagram of the refurbished staff base – Adult Assessment area, Emergency Care. Walls have been removed to create an ‘open plan’ environment.

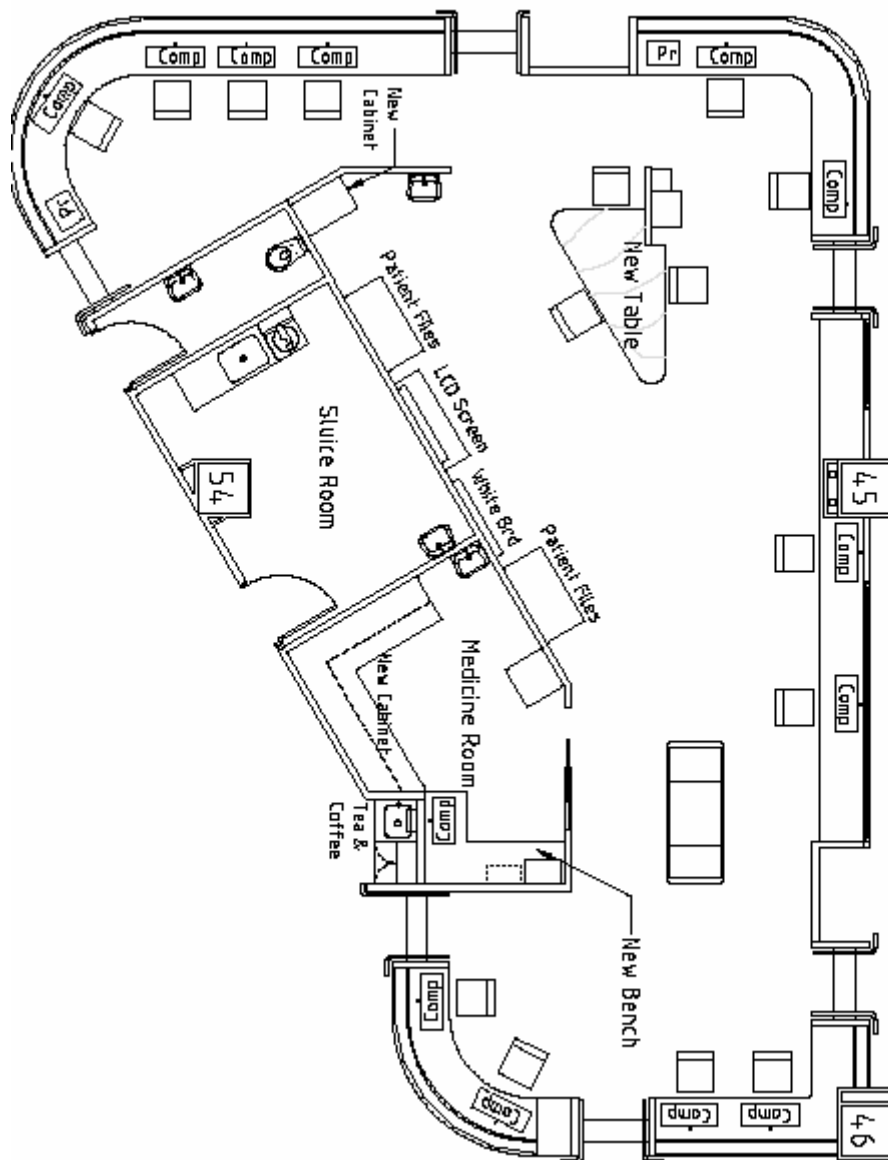

Two apprentices join the team at Middlemore Hospital

Meet Middlemore Hospital's two apprentices, Andrew Turner (Plumbing) and Sao Tone (Carpentry).

Andrew has just started a four year apprenticeship, while Sao has two years to go.

"I have always wanted to be a qualified tradesman and jumped at the opportunity to train at a large organisation," says Andrew.

"Middlemore Hospital provides a variety of opportunities I wouldn't find in a smaller organisation.



Andrew and Sao

"It's also great to work for an employer that is committed and supportive towards my training."

Sao has spent the majority of his apprenticeship working alongside the Hospital Carpenters and is currently spending 6 months with Hawkins Construction.

"I'm picking up a wide range of skills," says Sao. The variety is great and every day is different."

Both Andrew and Sao still find it a challenge to find their way around the Hospital.

"It's hard when you need to locate faults quickly, says Andrew. "Everything at Middlemore Hospital seems to be on a big scale."

Both agree that support is always available.

"It's good to work independently, however it's reassuring to know that help is available should you need it," says Sao.

The Engineers and Plumbers work from 7.30 am – 4 pm and can be found at the back of Building 27.

Keeping our Hospital safe

Terry Jordan has spent the past 6 years as a Fire Safety Officer and is responsible for delivering training in the area of fire safety and awareness to all staff on the Counties Manukau District Health Board (CMDHB) sites.

He brings with him 25 years of experience working for the New Zealand Fire Service.

The job is a busy one, not surprising when Terry is responsible for 28 properties, its occupants and 66 fire alarm systems within these buildings.



Terry carries out safety checks from the Fire Room

Responsibilities include checking, testing and maintaining fire systems, staff training, trial evacuations, dealing with staff concerns and liaising with contractors, the Fire Service and the Hospital Fire Response team (Duty Managers, Orderlies, Telephone Exchange and Security).

Terry also plays an important role when it comes to commissioning our new facilities.

“Keeping up with all the building projects can be a challenge,” says Terry. “The trick is to get involved during the concept stage of each new project. That way I can ensure that all fire points are in appropriate places and that hose connections and other fire equipment are conveniently placed for the Fire Service if required.

“Vigorous fire testing is also carried out before staff move in. It’s important that staff and patients feel safe in their new environment.”

Substantial improvements have been made over the past 6 years. Of particular mention is the drop in the amount of fire alarms that operate throughout Counties Manukau. For e.g. in 2000 there were 100 fire calls compared to 38 fire calls in 2006.

Terry puts this down to sound processes and systems along with ongoing training and education of staff.

As we enter into a period of growth and redevelopment it's important to understand our historical beginnings. Each issue of Towards 20/20 NEWS will take you on a journey through the past 60 years.

The Laboratory Service. This article was written by Des Philip and was previously published in Middlemore Memories - The first 50 years of Middlemore Hospital.

When the Laboratory opened at Middlemore in 1947, it did so under Rex Aitken, fresh from an army appointment, as the chief technologist, in the Pacific war theatre. Rex, was a man of immense ingenuity – an essential characteristic from his army appointment where he was kept woefully short of equipment.

In those days the Laboratory services in Auckland were unified and under the Director of Pathology Services who at the time was the delightfully eccentric Selwyn Hills. He was a great boat-builder and I recall the time when large pieces of wood were taken up in the lift of the Wallace Block at Auckland to be glued and bolted together in Dr Hills' room. The gluing completed, these large boat frames were taken back to the lift. For the life of me I cannot remember how they finally descended to the ground floor.

It was perhaps partly due to his inventiveness that Selwyn had Rex posted to Middlemore and quickly followed him with the Intravenous Manufacturing Unit, which occupied the large space at the back of the Laboratory.

Rex's inventiveness was soon seen in the IVS (Intravenous Supply) Department. Although bottles from Abbotts were re-used for solution manufacture, locally made bottles were also used. They had a decided drawback as during sterilisation there was an unacceptable flaking from the glass walls. Rex built what could only be described as a contraption that sprayed hot Potassium dichromate solution into the bottles. One shudders to think what Occupational Health and Safety's reaction would have been.

The other expediency was to store the new bottles outside and let them weather. So great masses of crates were stacked in the area between Pharmacy and the Laboratory much to the annoyance of Colonel Clarrie Newman, the house manager, who loved to have a neat and tidy ship.

Because of Rex, Middlemore's Laboratory could claim to estimate haemoglobins by photometric methods before the other Laboratories in Auckland. While the others were still using Sahli haemoglobinometers, Rex crafted a photometer from two tulle gras tins and a photoelectric selenium cell purchased from the army surplus store in Queen street.

When Rex left his replacement was Ian Cole.

It was around this time that the "Great Fire" occurred. The blaze started during the night when no-one was on duty in the Laboratory. Fortunately the Laboratory was isolated from the patient areas and the fire was restricted to the Laboratory and IVS area. The cause was isolated to a settee squab in the lunch room and the charitable view was that a spark from some welding equipment being used during the day had started smouldering, which fanned into flames during the night. Be that as it may, it was noted that the smokers in the Laboratory were especially careful with their butts after the fire.

From the Laboratory's perspective the fire meant two things. The IVS Department was transferred back to Auckland and the Laboratory acquired new and even more cramped accommodation in three small rooms which were part of the physiotherapy department - by the gymnasium. Cramped it may have been, but it was on the passage leading to the J.M.R.O's (Junior Medical Registrar Officers) quarters and liaison between Medical and Laboratory staff was never higher!

In 1951 Ian Cole was transferred to the Green Lane Laboratory and I was appointed to the principal technologist position – a position I was to hold for the next 37 years.

The Hospital Board seemed in no hurry to refurbish the burnt-out area and the hospitality of the physiotherapy department extended for over a year. Now with the IVS Department gone and many walls destroyed, there was a golden opportunity to construct a purpose-built Laboratory. However, no one seemed to anticipate the future and the most that was done to the old IVS unit was to paint the burnt studs with whitewash and lay a few of the loose floorboards over the matron's office. The rest of the Laboratory was restored much as it was before, although the office housing one person became the size of a small ballroom.

More from the Laboratory in the next issue ...



The Laboratory staff in 1970. Seated in the centre front is Des Philip with horn rimmed glasses, Renzi Palmer in the suit and Don McArthur. A number of staff pictured here are still working in the Laboratory today.



Contact

Communications Coordinator
Janet Haley
TOWARDS 20.20
Counties Manukau District Health Board.
C/- Projects Office, Building 25
Private Bag 94052
South Auckland Mail Centre
Auckland
Ph: (09) 262-9500
Fax: (09) 270 9714
Mobile: 021 443 731
Email: haleyj@middlemore.co.nz
Web: www.cmdhb.org.nz

