

News from the Facilities Modernisation Project

Managing health and safety on our construction sites

The safety of staff and public, while maintaining the day to day running of Middlemore Hospital, is a priority for Counties Manukau District Health Board and Hawkins Construction.

All construction sites have safety measures in place, however recent incidents have lead Hawkins Construction to reassess and improve some of its practices.

One initiative has been the appointment of a new Hawkins Health and Safety Officer, Bruce Hodge. Bruce monitors all construction sites on a daily basis to identify and control any hazards that may cause injury. An important part of his role involves putting in place safe practices and ensuring they are complied with.

For example Bruce is checking that everyone working on site is aware of safety procedures when using high risk equipment such as grinders and blow torches, which can pose a fire risk if not managed properly.

"Before a job starts all safety concerns are discussed with the person carrying out the work and measures put in place to ensure the job is concluded in a safe manner," says Bruce Hodge.

"A Hawkins Representative inspects the work on completion and only signs off once all safety requirements have been met." he says.

Other health and safety measures are also in place. For example in the event of flooding all construction floors have a water retention kit and emergency contact lists are posted around the construction sites in full view should an incident occur.

A formal shut down procedure is also carried out for each construction site at the end of each day.

Challenges such as noise, dust and contamination are covered by the site team going through a detailed risk assessment and planning stage before the work starts.

"Everyone who works on site has been trained by Site Safe," says Bruce Hodge. "We run safety inductions and weekly safety toolbox meetings to ensure everyone is up to date with safety requirements."

Fortnightly construction impact meetings are held with Hawkins, Counties Manukau District Health Board, Occupational Health and Safety, Infection Control and RCP Project Managers.

At these meetings construction work planned over the next two weeks is discussed and safety measures put in place to minimise any disruptions to hospital operations.



Hawkins Health & Safety Officer, Bruce Hodge

Inside this Issue ...

New buildings bring many opportunities.

Artwork brightens up new Intensive Care Unit Waiting Room.

Opening of new Spiritual Centre - "One place for all"

Making our buildings accessible.

Building 31 refurbishment.

Construction updates.

Construction photo page.

Stage 6 Radiology complete.

Official opening of the Cardiac Catheter Laboratory.

What's going on behind the scenes for National Burn Centre.

Future planning underway.

New buildings bring many opportunities

Counties Manukau District Health Board (CMDHB) would like to welcome Ron Dunham to the position of Director Projects, Planning and Service Reconfiguration. Ron and his team will be responsible for ensuring our future facilities and services provide the best clinical service to patients and the community, both now and in the future.

"CMDHB has a rare opportunity to design future buildings to reflect best practice and allow clinical and support staff to do their jobs well," says Ron Dunham.

"The modernisation of the Hospital doesn't start with designing buildings, it starts with designing processes which influence the design and the layout of the building," he says.



Ron Dunham

"How many times do we hear staff comment that they could provide a better service if systems and buildings were designed differently," says Ron Dunham.

"Well now is your chance. Before the architects start drawing up the design of our future facilities I want everyone to be sure that the building will reflect how clinical and support staff want to operate.

"New buildings provide many opportunities such as challenging the 'way we do things around here'. I will be leading a team of facilitators who will work with each department to develop and design service delivery processes that end up with the best possible outcomes.

"The other half of my role is the preparation of a business case for the longer term capacity needs. The rapid growth and the demographic changes in South Auckland means we have to be sure about what sort of facility capacity we will need in 20 years time. Once that is done we need to present to the Government a case for capital investment."

New artwork brightens up Intensive Care Unit Waiting Room

Year 12 King's College students, Suzanna Jacobsen and Lance Vazey, with the guidance of NZ Artist Michel Tuffery have produced two artwork panels for the new Intensive Care Unit (ICU) Waiting Room, which opened Thursday 20 October 2005.

The first panel is a combination of paint and carving. The tree symbolises life and carved into the trunk are kowhai flowers in a vine, while the top of the tree branches are filled with native birds. Maori tradition has a tree planted over the umbilical cord. The tree represents the cycle of life and connection with the earth.

Two tiki are focal points for the second panel which is also carved with bird motifs. The bold red and yellow steps to heaven and the graduated blue sky provide a further positive tone for an area in which people are so unwell.

Many thanks to Langham Hotel Auckland for their support. Thanks also to Bunnings Warehouse who generously supplied the materials for the artwork and Chas Foxall, Head of Department Art, King's College for the co-ordination of the artwork.

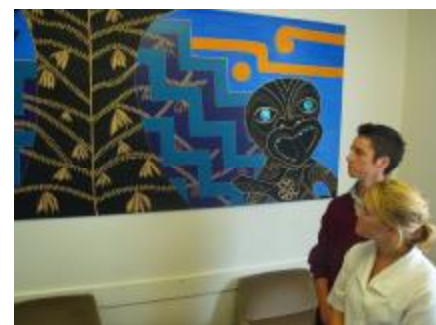

Students Suzanna Jacobsen & Lance Vazey



**Brad Healey General Manager
Clinical Support Division**

Opening of Spiritual Centre – “One place for all”

In December 2005 a new Spiritual Centre will open at Middlemore Hospital.

The Centre will be temporarily located by the loading bay in Building 17 until a permanent site is chosen.

Hospital Chaplain Irene Brodie says the Centre will be open to anyone regardless of faith who feels the need for time-out, prayer or quiet reflection.

“We have such a diverse population using the Hospital,” says Irene Brodie. “The Spiritual Centre should cater for everyone’s needs.”

Permanent sites for the Centre are being looked at and consultation has begun with community churches and faith bodies.

Funds are being raised with the help of the South Auckland Health Foundation along with a steering group committee from the community. To date \$100,000 has been collected.

The Spiritual Centre will offer Sunday worship, space for prayer and memorial services when required.

For more information or to support the fundraising campaign contact Project Manager Nicki Winn, phone (09) 270 8808.



From left to right Rev. Mika Faamausili, Rev. Irene Brodie, Sr. Mary Keane and Rev. Eru Wright

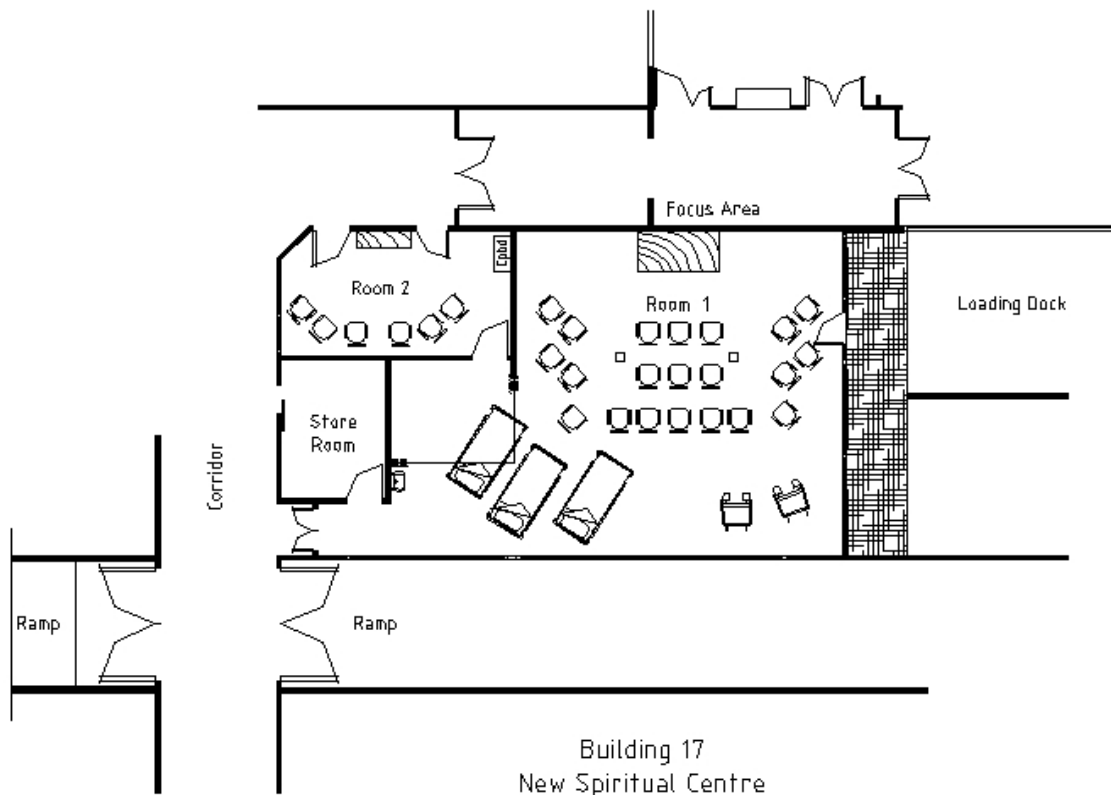

Making our buildings accessible for all

As a wheelchair user Gaylene Gaffney is passionate about making our buildings accessible for disabled people – be they with a physical, intellectual or sensory impairment.

Gaylene is an Accredited *Barrier Free Access Advisor and an Occupational Therapist.

What made you decide to become a Barrier Free Access Advisor and what did you have to do to obtain accreditation from the Barrier Free NZ Trust?

As a wheelchair user I have come across a lot of buildings and facilities that are not accessible to me, so I wanted to do something about it. All public buildings need to be fully accessible and useable under New Zealand law for disabled people.

Under the Barrier Free Trust programme I undertook an intensive training seminar, followed by a number of practical audits and reports. I needed to display a knowledge of current legislation, an understanding of appropriate actions to satisfy compliance requirements that are “reasonably practicable”, and that I could convey my findings clearly and accurately in a written report. These trial reports are assessed by a panel of independent professionally qualified people, who recommend your application to the Barrier Free Trust for accreditation as an Access Advisor. A refresher course is also required two yearly.

*Barrier-free means universal access design that aims to ensure that no one is physically excluded from use of any built environment by unnecessary architectural or engineering barriers.

When you assess or audit an area what are the main things you look for?

The facilities must be accessible and useable for all types of disabled people (ambulant disabled, visually-impaired, blind with a blind dog, deaf, hearing-impaired, people with learning difficulties and wheelchair users). I use a “wheel-through” sequence – so I’ll start from the outside of the building, noting the approach and entranceway (for such things as safety features, for example visibility of glass, projections into the path of travel, non-slip surfaces etc.) and look for signs to identify the accessible route. These should direct me to the useable facilities within the building. I’ll note the details of the accessible route and the facilities. This will include for example the lift and stairs, the doors - including its handles, approach and ease of opening. I’ll note the layout of the ward, and take specific measurements of the facilities including doorways, toilet and shower cubicle size, heights of fixtures etc. I spend a lot of time in toilets!

What are your main priorities in regard to future building projects?

One area I am looking at is the amount and location of accessible carparks throughout Middlemore Hospital. If the building and facilities within are compliant, but a disabled person can’t get to them the accessible journey is in tatters. Next is to ensure that all recently completed and new buildings at Middlemore meet Building Code compliance standard. It’s vital to be at the planning stage of the accessible design.

My vision is that every disabled person who comes to Middlemore has a positive experience about the buildings and facilities they use.



From Left to Right Gaylene Gaffney, Architects Haitham Alrubayee (Peddle Thorpe) and Rachael Rush (Klein).

To provide first-hand experience of a ward environment from a disabled person’s perspective Rachael and Haitham agreed to join Gaylene in a wheelchair.

Building 31 refurbishment will provide much needed space

Clinical services being provided within Building 31 AT & R (Assessment, Treatment and Rehabilitation Unit) have reached saturation point with regard to space. These services include Health Services for Older People, Neuro-rehabilitation, MHSOP (Mental Health Services for Older People) and NASC (Needs Assessment and Service Coordination).

In response to the growing demand for these services a decision was made to refurbish the Ground and 1st floor of Building 31.

“The first floor has been vacant for 13 years,” says Doug Blackstock, Mental Health Project Coordinator. “As well as releasing clinical space on the ground floor, the refurbishment offers an appropriate site to locate senior clinical staff from the combined AT & R services as well as some key members of the Mental Health/Intermediary Care Teams.

“The project also offers an ideal opportunity to look at the use of space on the ground floor of the building. For example the old kitchen area on the ground floor has been developed as an office for the Community based Rehabilitation Team, the toilets will be renovated and additional office space for six staff will be developed.”

What services will be moving to the 1st floor:

- Intermediary Care and Mental Health Management (Mental Health Management will relocate from The Cottage in Otahuhu).
- Senior staff from AT & R and MHSOP, MHSOP Community Team/Psychiatric District Nurses and NASC (Intermediary Care).

Approximately 60-65 staff will be accommodated on the first floor. Some meeting rooms will be available for booking.

Construction updates

Adult Medical Centre (AMC) Fit-Out - 3rd Floor

- Internal timber framing has commenced.
- HVAC, medical gas, sprinkler and electrical services are well underway.
- Doors and door hardware have been ordered.
- A temporary loading dock has been built on the end of the east wing.

Adult Medical Centre (AMC) Extensions

- External framing is continuing to floors 4-5 north wing.
- Aluminium windows are being manufactured.
- The roof is due to start this month (November 2005).
- The plant room slab for the 6th floor has been poured.
- Structural steel has commenced to the 5th floor east wing.
- Scaffolding continues to east wing.

Neonatal Intensive Care Unit (NICU)

At this stage the main focus is completion of the clinical areas.

- Currently the ceiling grid is being installed.
- Plaster Board is being applied to the wall frames, which once completed will be gib-stopped, sanded and ready for painting.
- The installation of electrical services continues.

National Burn Centre (NBC)

- Internal framing has commenced
- Plaster Board is being applied to the frames
- Cabling will commence shortly

Check out the latest construction photos

... as at 30 October 2005

Adult Medical Centre – 3rd Floor Fit-Out



Internal wall framing has commenced. The frames are put together on the ground and then lifted into place.

Adult Medical Centre - Extensions



Exterior View



4th Floor



Looking up onto the 5th Floor

Neonatal Intensive Care Unit



Staff Hub



Service panels in a Level 2, 4 cot bay



The installation of pipes, wires and ducts continue

National Burn Centre



Staff Hand-over Room



Staff Room/Education Room



Staff Station



High Dependency Rooms

What's going on behind the scenes for National Burn Centre

Construction is underway for the National Burn Centre, although there have been unforeseen delays – due to the decanting of Wards 14 & 15 to C pod in Kidz First, while work is carried out in the ceiling spaces. Assuming things run smoothly, the National Burn Centre is due to be completed during May 2006.

Once the building has been designed, signed off and construction begun, work does not stop for the User Group. The finer details need to be considered and confirmed. For example colour schemes, art work in public areas, signage, and equipment to be ordered. The model of care is an evolutionary process in that you design the building to deliver the model, but the model of care may also need to adapt to the facility. Simultaneously we are developing policies, procedures and guidelines that cover a number of professions and also the operational elements of the new facility.

Existing policies and procedures may need to be revised in light of the new facility and to reflect the new model of care. For example, it has been agreed that two of the high dependency patient rooms will be designated as paediatric rooms because of their close-proximity to the Staff Station. There will be certain restrictions in place when these rooms are occupied by a child, and this should be included within a policy for existing and new staff, which will become part of the orientation process to the new Unit.

Future planning underway

There is a lot of building activity happening at the moment – not surprising when there are numerous construction sites on the go, however it's important not to lose site of the big picture and recognise that a three phase development is needed to support the growing needs of our community over the next 20 years.

This includes Phase 1 – Current Projects, Phase 2 – Core Consolidation (work required in the immediate future) and Phase 3 - Planning for future growth over the next 20 years.

Most of us are familiar with Phase 1 or current projects, however we are about to move into an exciting and challenging Phase 2 or as the FMP Team calls it 'Core Consolidation'.

This \$95 million Core Consolidation Phase is based on an in-depth analysis of the predicted health needs of the people of Counties Manukau, an assessment of the most appropriate and effective means of delivering their health care, a review of the existing asset base, and an assessment of the assets required to meet the predicted healthcare needs.

A business case for this phase has just been approved by the Board and is now waiting approval by the Ministry of Health (early 2006).

Many options for future growth and development are being explored and once approved the FMP Team will update you.

What we can tell you is that the next phase of development provides us with an opportunity to offer a health system that reflects best practice around the quality of care we provide and the processes that make it happen.

This is our chance to get it right.



Stage 6 Radiology complete



Nurses Station

Stage 6 Radiology was completed on 18 October 2005, with staff moving in on 19 October 2005.



Change Room



Ultrasound Room

This area provides a new Ultrasound Department, waiting room, reception area and interventional room.



Reporting Room

Official opening Cardiac Catheter Laboratory

Approximately 200 people turned up to the official opening of the Cardiac Catheter Laboratory on Friday 7 October 2005.

Many were acknowledged for their hard work and support throughout the Project.

Since opening its doors the Catheter Laboratory has seen over 100 cases!



Contact details – Project Managers:

Neonatal Intensive Care Unit (NICU)

Bruce Hancock – Counties Manukau District Health Board (CMDHB).

Mob: 021 634 259

Paul Miller – RCP Project Management

Mob: 021 752 245

National Burn Centre (NBC)

Chris Jaggs – CMDHB

Mob: 021 784 204

Matt Allen – RCP Project Management

Mob: 021 866 929

Adult Medical Centre (AMC) – Level 3 Fit-Out

Chris Jaggs – CMDHB

Mob: 021 784 204

Matt Allen – RCP Project Management

Mob: 021 866 929

Adult Medical Centre (AMC) – Extra Levels

Chris Jaggs – CMDHB

Mob: 021 784 204

Matt Allen – RCP Project Management

Mob: 021 866 929

AT & R (Current construction)

Graeme Purdie - CMDHB

Mob: 021 283 3054 OR

Doug Blackstock

Mob: 027 455 7512

Radiology

Graeme Purdie – CMDHB

Mob: 021 283 3054



Ward 14 has temporarily MOVED into Ward 15

To jog your memory access to the ceiling spaces above Wards 14 and 15 in the Galbraith Building was required so building works could continue for the new Neonatal Intensive Care Unit (NICU).

Building works have now finished in Ward 15 and work has begun in the ceiling space above ward 14.

To minimise disruption patients and staff from Ward 14 have moved into vacated Ward 15, where they will stay until approximately 28 November 2005.

Please note patients and staff from Ward 15 remain in C-Pod Kidz First Surgical.

Business as usual for Adult Medical Centre tenants

Many of you will have noticed the scaffolding and construction activity around the Adult Medical Centre.

We would like to thank all the tenants for their cooperation and patience during this time and would like to re-enforce that operating hours and access to these areas remain unchanged.



Don't forget to check out the FMP Intranet or Internet site.

Go to 'Projects' on SouthNet or go to www.cmdhb.govt.nz